

- 1.** Remove the fixture from its original packaging. Remove the canopy mounting plate from within the canopy and attach it to the electrical junction box on the wall using the two screws provided in the hardware package.
- 2.** Attach the canopy to the mounting plate, which is attached to the electrical junction box on the wall. First attach all wiring with the provided marrets (white to white "N", black to black "L", ground to ground "G"). Push the screws through the canopy plate so they are poking through, once this is complete you can screw on the decorative nuts until tight.
- 3.** You can now install the A-19 light bulb of the correct wattage.
- 4.** Locate the three pins from inside the hardware package. These pins are to hold the glass onto the fixture. **(4a)** Guide the lamp socket gently through the center of the smaller glass piece until one of the holes in the glass lines up with one of the holes in the metal disc below the lamp socket. Now insert a pin through the hole in the glass, and screw it in to the hole on the metal disc, until it is tight (do not over tighten). **(4b)** Take the smaller glass piece and guide it gently through the center of the bigger glass piece until one of the holes in the glass lines up with the pin, and then insert the pin into the hole. Now with both pieces of glass are installed on the fixture, please proceed to line up the other two holes in the glass with the holes in the metal disc, insert the pins, and screw them in until they are tight (do not over tighten).
- 5.** You have now completed the installation of your fixture, please enjoy.

### START FROM HERE

- Make sure power is completely off at the fuse box.
- Have your fixture installed by a qualified licensed electrician
- Prepare everything in clear area.
- Wear gloves at all times during this installation.
- Read instructions carefully before you start assembly.
- Keep this instruction sheet for future reference.

**Technical Support:** 1-877-452-6858

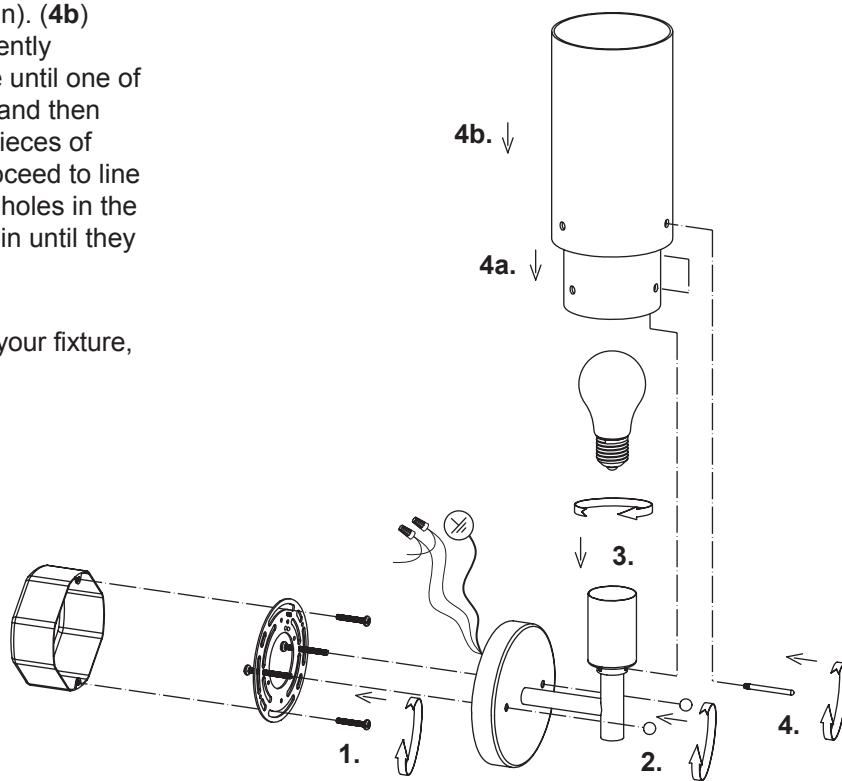

**KUZCO**  
LIGHTING

19054 28th Avenue Surrey, BC Canada V3Z 6M3  
T: 604 538 7162 TF: 1-855 85 KUZCO F: 604 538 7196  
W: kuzcolighting.com  
20140616